



KENSINGTON[®]

Finest Properties International

New Developments La Garriga - residential area international school



general:

object number external:	KBMN215	Date:	26.07.2024
usage:	habitation	marketing method:	purchase
property:	House	place:	08530 La Garriga
living space:	168,00 m ²	Number of Rooms:	5,0
Number of bedrooms:	4,0	Number of bathrooms:	4,0
number of parking spaces:	2,0		

prices:

:	0,00 €	purchase price:	565.000,00 €
---	--------	------------------------	--------------

energy certificate:

contact person:

company:	Indisi Group S.L.	name:	Angela Navas
street:	Port Balis 3	place:	08392 Sant Andreu de Llavaneres
phone:	+34 931 591 558	Email:	angela.navas@kensington-international.com
www:	www.kensington-maresme.com		

Infrastructure:

Description:

This residential complex located in the town of La Garriga, a few meters from one of the best international schools and at the foot of the Montseny Natural Park, consists of nine semi-detached houses, with double orientation, with four bedrooms plus multipurpose room, exterior, with private garden front and rear, with private parking for two cars in basement with motorized access door with remote control.

The house communicates vertically by elevator, making it an accessible house without barriers in its environment, allowing people with reduced mobility to enjoy the whole house.

The general flooring is of high quality laminated floating parquet, with photovoltaic panels for the generation of

electricity for use in the house itself. Energy certificate project A with underfloor heating, aluminum windows with motorized blinds.

Contact us for more detailed information, specifications and delivery time!

Location:

Its location near Barcelona, its climate, and the presence of thermal waters made La Garriga one of the favorite summer resorts of the Catalan bourgeoisie of the early twentieth century, a fact that led to the construction of modernist buildings in the town. With all kinds of services, international schools such as SEK and ISCAT, medical center, cinema, theater, thermal spas and transportation by bus and RENFE line R3 that connects towards Barcelona and Puigcerdà. Its location on the shores of the Montseny Natural Park keeps it as one of the favorite towns of the Vallés Oriental.

Equipment description:

Elevator
2 parking spaces
Residential area Colegio Internacional
4 bedrooms
4 bathrooms
Solar panels
Underfloor heating
Motorized blinds

images





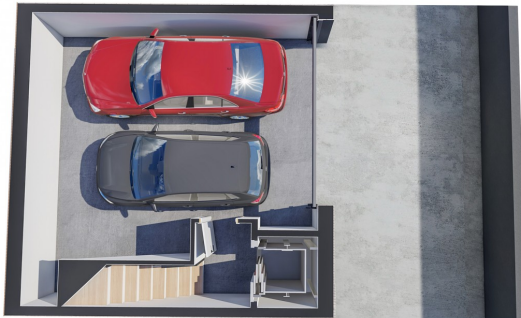



PLANTA BAIXA ↻



PLANTA SEGONA ↻

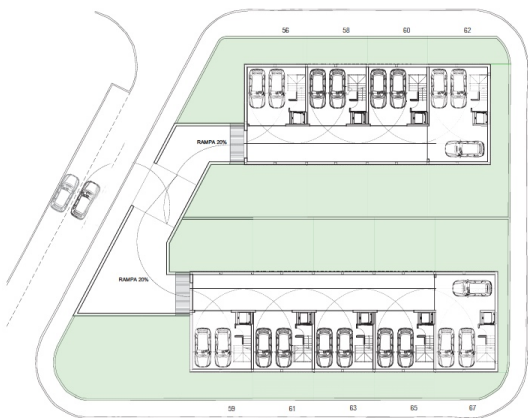

PLANTA SOTERRANI ↻